

Technology Tid-Bits

NNPS Links



Submit Technology Work Orders by:

- Click on the above help desk icon or the icon on your desktop

Student Login Information:

- Student Username:** first.last name
- Student Password:** birthdate (MMDDYY)
- Change Password:**
 - at least 6 characters
 - at least 1 alpha character
 - at least 1 non-alpha character

Technology Staff

ITC Betsy Orlando

- Instructional
- Software
- Co-teach/model lessons
- Observe technology integration
- Collaborate/plan with teachers
- Conduct PD sessions
- **x-45413**

TSS Glenn Riter

- Technical
- Hardware
- Make sure all technology equipment is kept in good working order.
- **x-45411**

How Do I...

Hard-Wire my Laptop?

There are **2 ports** on the **back of your phone**. One goes to the data port on the wall and the other should go to your laptop.

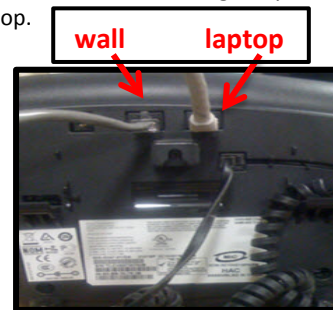

Find my blocked e-mail?

- spam.nn.k12.va.us
- Username: firstname.lastname
Password: same as your computer



PDMS



SIS

Username: firstname.lastname
Password: same as your computer



ITC Help Request Form...

- Instructional Technology Integration
- Training Session (1 on 1 or small/large groups)
- Coaching (Collaborative Planning)

Reserve lab, carts and all other technology equipment?

- Computer Labs and Laptop Carts Calendar**

Username: **mhsstaff**
Password: **mhsstaff**

Please return and plug-in carts by 4:30 each day, to ensure the carts are charged for the next user.



Username: nnp\firstname.lastname
Password: same as computer

PowerSchool
For Teachers:



Username: NNPS e-mail address
Password: same as your computer



PowerTest
For Students:
Student ID # only

Update Software?

- Double-click the KACE icon on desktop
- Go to [Software Portal](#) and login with computer credentials



Username: Employee ID number (no leading zeros) followed by last name
Password:

Request a Substitute



TalentED- Teacher Evaluation



Access Sharepoint?

From the school's homepage:

- Go to Employees
- Select desired Sharepoint link

